



# ESBE®

## CONTROL MOTOR SERIES 60



The ESBE series 60 is a compact control motor designed for operating ESBE rotary mixing valves up to 2". The motor is reversible with fixed end limit switches for an operating range of 90°.

The valve can be manually operated by the knob on the front of the control motor.

The ESBE series 60 is available for 24 VAC, 50/60 Hz. It is supplied with a 60" (150 cm) connection cable attached.

The motor series 60 can be supplied with a fully adjustable auxiliary switch for additional control or indication.

This switch can be set in any position and in any direction by adjusting a cam under the front cover. Please order Art.No. 62M for this option.

Technical data:

Supply voltage: 24 VAC, 50-60 Hz

Power consumption: 1,5 VA (62 P = 1,3 VA)

Torque: 45 in.lb.

Protection type: NEMA 1 (IP 40)

Ambient temperature range: 22 to +130° F

(-25 to +65°C)

Weight: 1 lb.

Art. No.	Supply voltage	Running time/90°	Operation
62	24 VAC, 60 Hz	1.7 min.	3-point
62 M	24 VAC, 60 Hz	1.7 min.	3-point
62P	24 VAC, 60 Hz	60, 90 or 120 sec	0-10 V, 2-10 V 0-20 mA, 4-20 mA

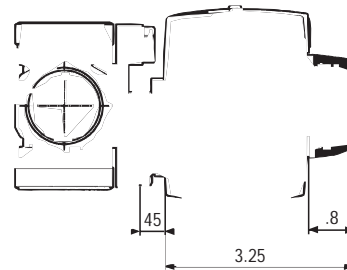
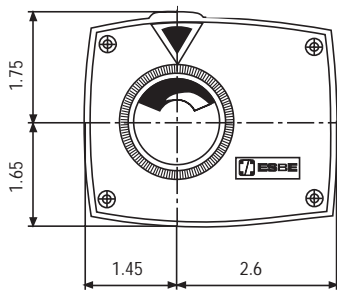

Available at:

# PEXHEAT.COM